

# METAL HOOD SPECIFICATION SHEET:

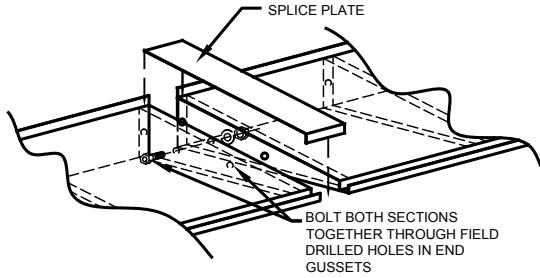

NOTE:  
HOODS OVER 12' IN LENGTH  
HAVE TO BE CONNECTED  
TOGETHER WITH AN OVERLAP  
SPLICE PLATE

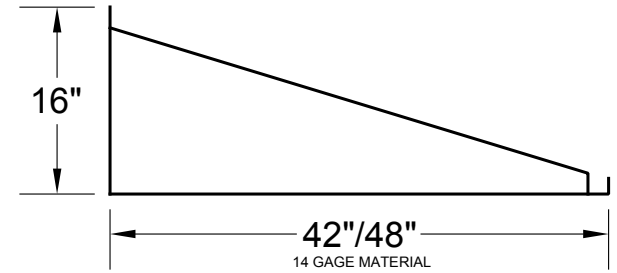
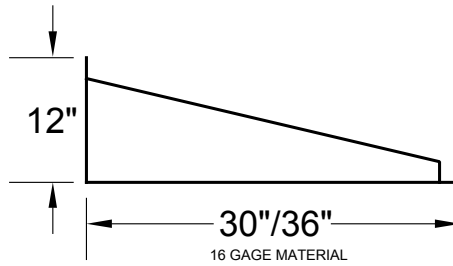
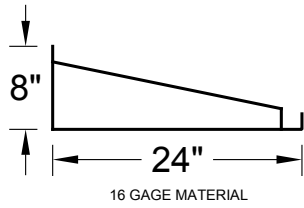
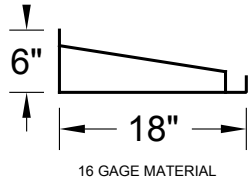
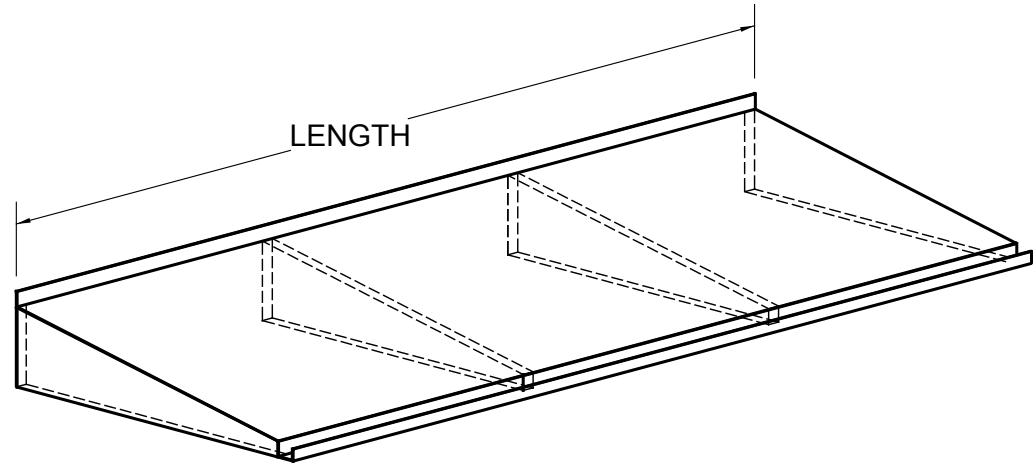

## MOUNTING OPTIONS

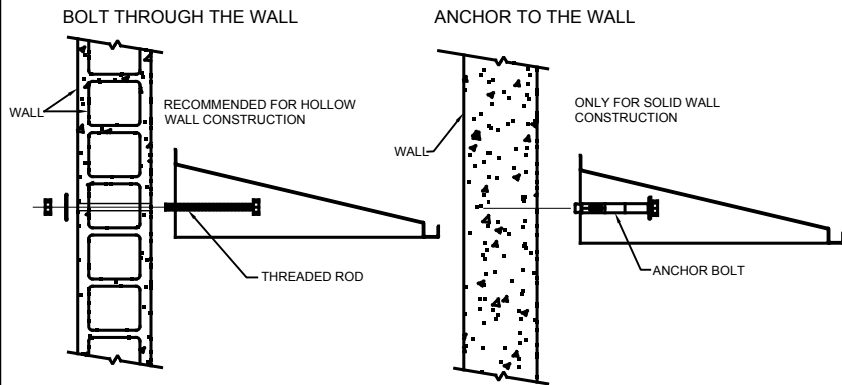

QUANTITY: _____ SIZE: <input type="checkbox"/> ___" L x 18" PROJ. x 6" H 16 ga. <input type="checkbox"/> ___" L x 24" PROJ. x 8" H 16 ga. <input type="checkbox"/> ___" L x 30" PROJ. x 12" H 16 ga. <input type="checkbox"/> ___" L x 36" PROJ. x 12" H 16 ga. <input type="checkbox"/> ___" L x 42" PROJ. x 16" H 14 ga. <input type="checkbox"/> ___" L x 48" PROJ. x 16" H 14 ga.	<p align="center"><b>SPECIAL SIZE INFORMATION</b></p> <p align="center">SPECIAL SIZES AVAILABLE - MAX 48" PROJECTION</p>
--	--

GUSSET PER LENGTH		TABS PER LENGTH	
2	1'-5'	2	1'-5'
3	6'-7'	3	6'-9'
4	8'-10'	4	10'-12'
5	10'-12'		

**PERMA TECH, INC.**  
 363 HAMBURG STREET • BUFFALO, NY 14204  
 (716) 854-0707 • 1-800-DOC-SEAL

JOB: \_\_\_\_\_

DEALER: \_\_\_\_\_

CONTRACTOR: \_\_\_\_\_ QUOTE: \_\_\_\_\_

APPROVED BY SIGNATURE: \_\_\_\_\_ DRAWN BY: C.BAYERL DATE: 11/06/2020

## NOTES